

SPECIFICATIONS OF ES BATTERIES

BATTERY Type	Nominal Voltage (V)	RATED CAPACITY					MAXIMUM CHARGING CURRENT (A)	CHARGING VOLTAGE		DIMENSIONS (mm) ± 5mm				WEIGHT APPROX KGS + 3%	TERMINAL TYPE
		20HR 1.75 V CELL	10HR 1.75 V CELL	5HR 1.75 V CELL	3HR 1.75 V CELL	1HR 1.75 V CELL		STAND BY USE V	CYCLE USE (V)	LENGTH	WIDTH	HEIGHT	TOTAL HEIGHT		
ES 7-12	12	7	6.28	5.55	4.86	3.72	1.75	13.50 TO 13.80 V at 25(°C) (77°F)	13.50 TO 13.80 V at 25(°C) (77°F)	151	65	94	100	1.90	F2
ES 12-12	12	12	11.08	10.15	9.3	7.34	3			151	98	95	101	3.7	F2
ES18-12	12	18	16.65	15.3	13.77	10.6	4.5			181.5	77	167.5	167	5.32	F3
ES 26-12	12	26	23.93	21.85	20.7	17.8	6.5			166.5	175	125	125	7.6	F3
ES 42-12	12	42	39.78	37.55	31.8	24.2	10.5			197	165	170	170	12.9	M6
ES 65-12	12	65	60.50	56	50.7	35.9	16.25			348	167	178	178	19.2	M6

SPECIFICATIONS OF ESC BATTERIES

ESC 100-12	12	100	91.50	83	70.5	58.9	25	13.50 TO 13.80 V at 25(°C) (77°F)	13.50 TO 13.80 V at 25(°C) (77°F)	330	171	215	222	29.5	M8
ESC 120-12	12	120	108.00	96	84	69.1	30			410	176	227	227	33.5	M8
ESC 150-12	12	150	141.75	133.5	121.5	89.3	37.5			485	172	240	240	42.5	M8
ESC 200-12	12	200	186.75	173.5	141.3	120	50			522	238	218	223	58.5	M8

The Battery Container & Cover are Available in ABS Plastic & Flame Retardant (FR).

COMPLIANCE STANDARDS

JIS

IEC 60896 PART 1&2

BS6290-4,

Eurobat Guide-HIGH Performance

TERMINAL

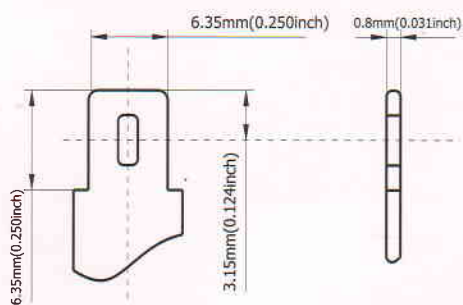

Terminal F2 (0.250)

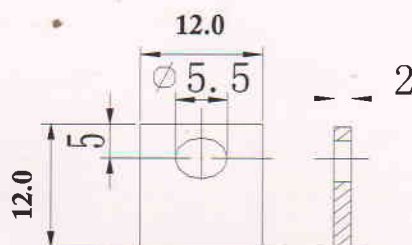
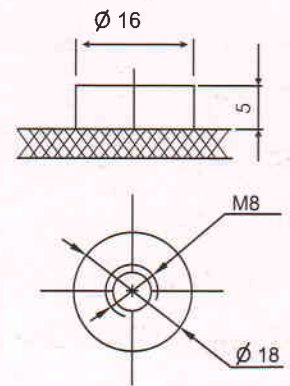
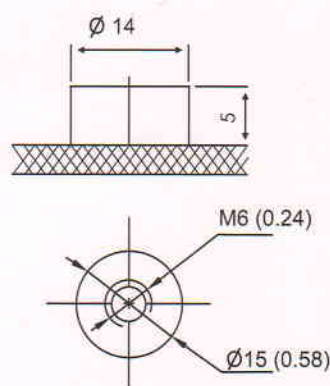

Terminal F3

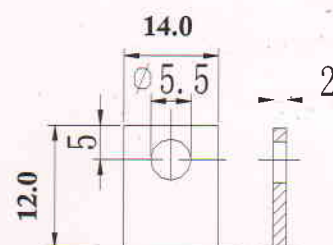

Terminal F4

Note : Above data is only for indicative purpose. For more detail please visit our website www.rocketbatteries.net